

# FF15

## TABLETOP VIAL/BOTTLE HANDLING SYSTEM

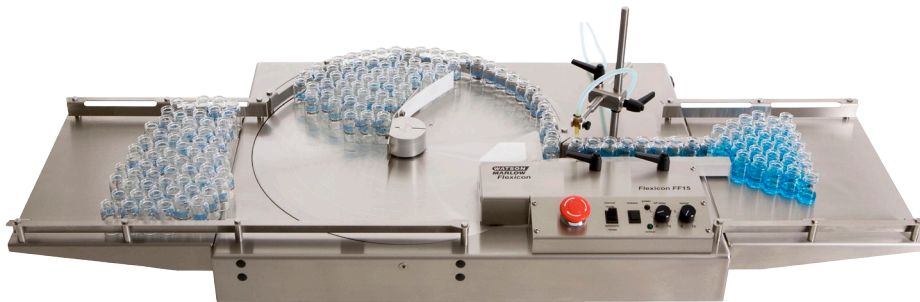

- For filling under laminar air flow or in bio-safety cabinets
- Ø12mm/0.55" – Ø48 mm/1.89" bottles
- Fast change-over / no format parts
- Capacity up to 2,000 bottles per hour
- Protects operators from repetitive strain injuries (R.S.I)
- Accurate filling if peristaltic filler is applied



## Watson-Marlow Flexicon

Frejasvej 2-6  
DK-4100 Ringsted  
Denmark  
Tel. +45 57 67 11 55  
Fax. +45 57 67 05 41  
flexicon@flexicon.dk  
www.wmflexicon.dk



# FF15

# TECHNICAL SPECIFICATIONS

FF15 is a rotary vial/bottle handling system designed for use with Watson-Marlow Flexicon's peristaltic liquid filling systems or cream filler.

It can deliver up to 2,000 fills per hour. At the same time FF15 provides a consistent production quality that is unobtainable when using a manual or semi-automatic system. Even unstable vials/bottles can be filled by FF15 as the speed by which the vials/bottles are presented at the filling needle is fully adjustable.

Liquids can be filled automatically in volumes from 0.1 ml to approx. 100 ml.

### Key applications:

- R&D Departments
- Hospital pharmacies
- Contract fillers/packers
- Diagnostic industry
- Manufacturers of essential oils
- Cosmetic industry

A bottle size change on a FF15/PF6 combination takes approximately 2 minutes, whereas a complete liquid and bottle size change can be completed in just 5 minutes.

### Main features:

- Small foot print allows for use in laminar air flow units or bio-safety cabinets
- Ø12mm/0.55" – Ø48 mm/1.89" bottles
- No format parts
- Change-over in 2 minutes
- Protects operators from repetitive strain injuries (R.S.I)
- Limited air turbulence when installed below LAF
- Easy to clean
- Intuitive and solid design of user panel - HMI
- Speed adjustable according to stability and weight of bottle
- Accurate filling if peristaltic filler is connected
- Peristaltic filling prevents cross contamination between product to be filled
- Designed for intensive use

### Optional fillers (not incl.):

- PF6 peristaltic filler
- MC12/PD12 peristaltic filler
- 520 Di peristaltic filler
- DF32 positive displacement filler
- GF30 gear filler

### Optional capping machines to be applied next to FF15 (not incl.):

- FC10 or FC32 for screw caps
- FS10 or FS32 for crimp caps

### Mains:

110/230 VAC earthed - 50/60 Hz

### Power consumption:

100W

### Air supply:

Clean and dry air at 6 bar, 25 l/min free air by 2,000 fills/hour

### Bottle sizes:

Diameter: Ø12mm/0.55" to Ø48/1.89"

### Weight:

Approx. 30 kg

### Capacity:

Up to 2,000 bottles per hour depending on filling volume and the operator

### Materials:

AISI304 stainless steel, anodised aluminium and Polyacetal

### Ingress protection:

IP31

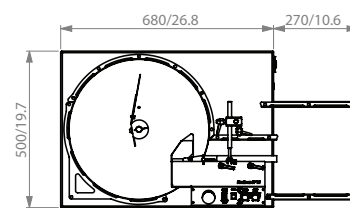
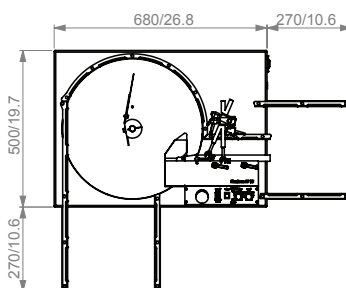
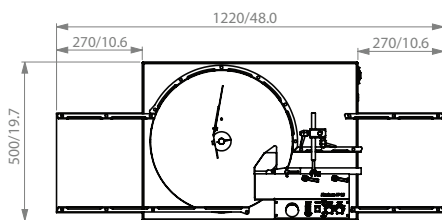

Dimensions in mm/inch

Watson-Marlow Flexicon cannot be held responsible for any errors or omissions. Subject to change without notice.

Rev. 23.11.2010